

# Composites USA, Inc. - FRP Fitting Standards

**Fitting Style No. 140**

**Product Class:**

**DG**

**Order as: #140 - "D"**

#140 FxP - "D" for flange by plain end

#140 FxF - "D" for flange by flange end

**Resin Type:**

**Dual Guard**

**Project Identification:**

**Standard**

**Corrosion Allowance:**

**0.000**

**Note:** Thickness may vary dependent upon rib location

## 90° 3-GORE EASY BEND RECTANGULAR ELBOW

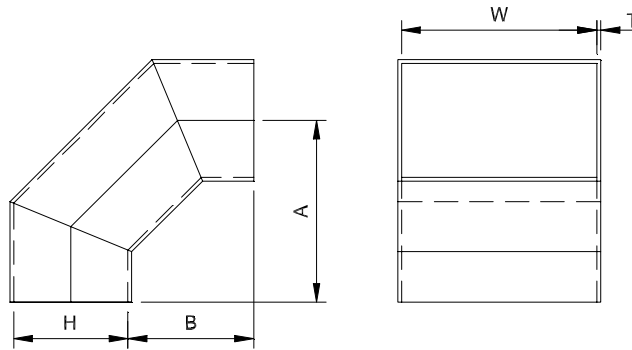

Width "W"	Height "H"	Thickness, "T"		Center-Line Radius "A"	Throat Radius "B"	Width "W"	Height "H"	Thickness, "T"		Center-Line Radius "A"	Throat Radius "B"
inches	inches	inches	mm	inches	inches	inches	inches	inches	mm	inches	inches
1	<math>\leq W</math>	0.150	4	1.5 x "H"	"H"	34	<math>\leq W</math>	0.190	5	1.5 x "H"	"H"
1 1/2	<math>\leq W</math>	0.150	4	1.5 x "H"	"H"	36	<math>\leq W</math>	0.190	5	1.5 x "H"	"H"
2	<math>\leq W</math>	0.150	4	1.5 x "H"	"H"	42	<math>\leq W</math>	0.260	7	1.5 x "H"	"H"
2 1/2	<math>\leq W</math>	0.150	4	1.5 x "H"	"H"	48	<math>\leq W</math>	0.260	7	1.5 x "H"	"H"
3	<math>\leq W</math>	0.150	4	1.5 x "H"	"H"	54	<math>\leq W</math>	0.260	7	1.5 x "H"	"H"
4	<math>\leq W</math>	0.150	4	1.5 x "H"	"H"	60	<math>\leq W</math>	0.260	7	1.5 x "H"	"H"
5	<math>\leq W</math>	0.150	4	1.5 x "H"	"H"	66	<math>\leq W</math>	0.260	7	1.5 x "H"	"H"
6	<math>\leq W</math>	0.150	4	1.5 x "H"	"H"	72	<math>\leq W</math>	0.313	8	1.5 x "H"	"H"
7	<math>\leq W</math>	0.150	4	1.5 x "H"	"H"	78	<math>\leq W</math>	0.350	9	1.5 x "H"	"H"
8	<math>\leq W</math>	0.150	4	1.5 x "H"	"H"	84	<math>\leq W</math>	0.350	9	1.5 x "H"	"H"
9	<math>\leq W</math>	0.150	4	1.5 x "H"	"H"	90	<math>\leq W</math>	0.375	10	1.5 x "H"	"H"
10	<math>\leq W</math>	0.150	4	1.5 x "H"	"H"	96	<math>\leq W</math>	0.375	10	1.5 x "H"	"H"
12	<math>\leq W</math>	0.150	4	1.5 x "H"	"H"	102	<math>\leq W</math>	0.375	10	1.5 x "H"	"H"
14	<math>\leq W</math>	0.150	4	1.5 x "H"	"H"	108	<math>\leq W</math>	0.375	10	1.5 x "H"	"H"
16	<math>\leq W</math>	0.150	4	1.5 x "H"	"H"	114	<math>\leq W</math>	0.375	10	1.5 x "H"	"H"
18	<math>\leq W</math>	0.150	4	1.5 x "H"	"H"	120	<math>\leq W</math>	0.375	10	1.5 x "H"	"H"
20	<math>\leq W</math>	0.150	4	1.5 x "H"	"H"	126	<math>\leq W</math>	0.375	10	1.5 x "H"	"H"
22	<math>\leq W</math>	0.150	4	1.5 x "H"	"H"	132	<math>\leq W</math>	0.375	10	1.5 x "H"	"H"
24	<math>\leq W</math>	0.190	5	1.5 x "H"	"H"	138	<math>\leq W</math>	0.375	10	1.5 x "H"	"H"
26	<math>\leq W</math>	0.190	5	1.5 x "H"	"H"	144	<math>\leq W</math>	0.375	10	1.5 x "H"	"H"
28	<math>\leq W</math>	0.190	5	1.5 x "H"	"H"	156	<math>\leq W</math>	0.375	10	1.5 x "H"	"H"
30	<math>\leq W</math>	0.190	5	1.5 x "H"	"H"	168	<math>\leq W</math>	0.375	10	1.5 x "H"	"H"
32	<math>\leq W</math>	0.190	5	1.5 x "H"	"H"	180	<math>\leq W</math>	0.375	10	1.5 x "H"	"H"

Composites USA

One Peninsula Drive, North East, MD USA 21901  
1-410-287-2700 Fax: 1-410-287-5222 info@compositesusa.com