

Composites USA, Inc. - FRP Fitting Standards

Fitting Style No. 145

Product Class: DG

Order as: #145 - "D"

#145 FxP - "D" for flange by plain end

#145 FxF - "D" for flange by flange end

Resin Type:

Project Identification:

Corrosion Allowance:

Dual Guard

Standard

0.000

Note: Thickness may vary dependent upon rib location

90° 3-GORE HARD BEND RECTANGULAR ELBOW

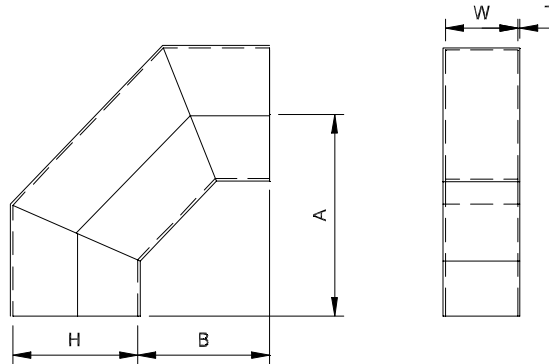

Height "H"	Width "W"	Thickness, "T"		Center-Line Radius "A"	Throat Radius "B"	Height "H"	Width "W"	Thickness, "T"		Center-Line Radius "A"	Throat Radius "B"
inches	inches	inches	mm	inches	inches	inches	inches	inches	mm	inches	inches
1	$\leq H$	0.150	4	1.5 x "H"	"H"	34	$\leq H$	0.190	5	1.5 x "H"	"H"
1 1/2	$\leq H$	0.150	4	1.5 x "H"	"H"	36	$\leq H$	0.190	5	1.5 x "H"	"H"
2	$\leq H$	0.150	4	1.5 x "H"	"H"	42	$\leq H$	0.260	7	1.5 x "H"	"H"
2 1/2	$\leq H$	0.150	4	1.5 x "H"	"H"	48	$\leq H$	0.260	7	1.5 x "H"	"H"
3	$\leq H$	0.150	4	1.5 x "H"	"H"	54	$\leq H$	0.260	7	1.5 x "H"	"H"
4	$\leq H$	0.150	4	1.5 x "H"	"H"	60	$\leq H$	0.260	7	1.5 x "H"	"H"
5	$\leq H$	0.150	4	1.5 x "H"	"H"	66	$\leq H$	0.260	7	1.5 x "H"	"H"
6	$\leq H$	0.150	4	1.5 x "H"	"H"	72	$\leq H$	0.313	8	1.5 x "H"	"H"
7	$\leq H$	0.150	4	1.5 x "H"	"H"	78	$\leq H$	0.350	9	1.5 x "H"	"H"
8	$\leq H$	0.150	4	1.5 x "H"	"H"	84	$\leq H$	0.350	9	1.5 x "H"	"H"
9	$\leq H$	0.150	4	1.5 x "H"	"H"	90	$\leq H$	0.375	10	1.5 x "H"	"H"
10	$\leq H$	0.150	4	1.5 x "H"	"H"	96	$\leq H$	0.375	10	1.5 x "H"	"H"
12	$\leq H$	0.150	4	1.5 x "H"	"H"	102	$\leq H$	0.375	10	1.5 x "H"	"H"
14	$\leq H$	0.150	4	1.5 x "H"	"H"	108	$\leq H$	0.375	10	1.5 x "H"	"H"
16	$\leq H$	0.150	4	1.5 x "H"	"H"	114	$\leq H$	0.375	10	1.5 x "H"	"H"
18	$\leq H$	0.150	4	1.5 x "H"	"H"	120	$\leq H$	0.375	10	1.5 x "H"	"H"
20	$\leq H$	0.150	4	1.5 x "H"	"H"	126	$\leq H$	0.375	10	1.5 x "H"	"H"
22	$\leq H$	0.150	4	1.5 x "H"	"H"	132	$\leq H$	0.375	10	1.5 x "H"	"H"
24	$\leq H$	0.190	5	1.5 x "H"	"H"	138	$\leq H$	0.375	10	1.5 x "H"	"H"
26	$\leq H$	0.190	5	1.5 x "H"	"H"	144	$\leq H$	0.375	10	1.5 x "H"	"H"
28	$\leq H$	0.190	5	1.5 x "H"	"H"	156	$\leq H$	0.375	10	1.5 x "H"	"H"
30	$\leq H$	0.190	5	1.5 x "H"	"H"	168	$\leq H$	0.375	10	1.5 x "H"	"H"
32	$\leq H$	0.190	5	1.5 x "H"	"H"	180	$\leq H$	0.375	10	1.5 x "H"	"H"

Composites USA

One Peninsula Drive, North East, MD USA 21901
1-410-287-2700 Fax: 1-410-287-5222 info@compositesusa.com