

# Composites USA, Inc. - Fitting Standards

Fitting Style No.: SS-133  
 Order as Fitting: SS-133

-"D"

Material: Pure Guard SS

- Options:
- Stainless bolt set
  - Stainless Flange Rings
  - Quick Clamps (Avail. <math>\leq 18''</math>)



**Project Specifications:** Standard Design & Materials, -6" w.c.  
 Ships standard with A-36 steel rings, SS rings >48" diameter, one plated bolt set and gasket

## 60° 4-GORE MITERED L.R. ELBOW

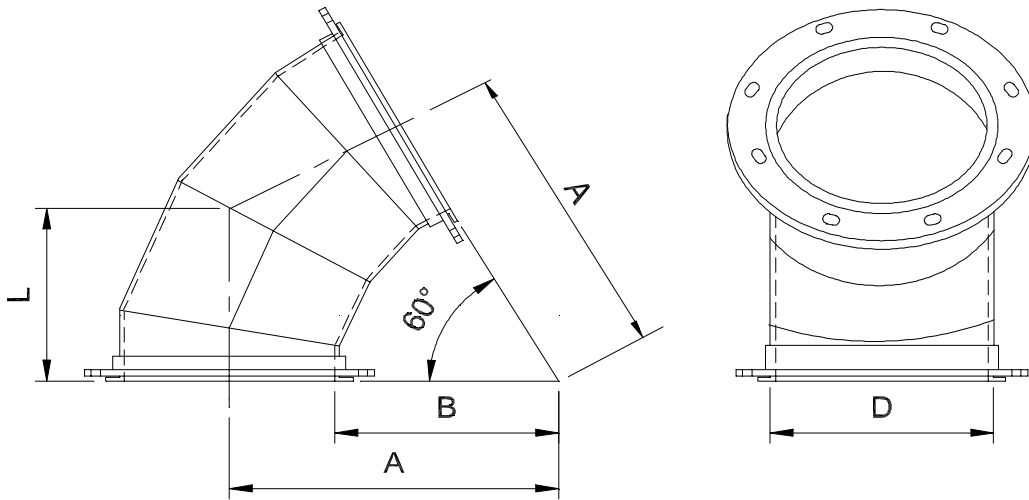

Diameter "D"		Face-Center "L"		Throat Radius "B"			Diameter "D"		Face-Center "L"		Throat Radius "B"	
inches	mm	inches	mm	inches	mm		inches	mm	inches	mm	inches	mm
4	102	3.46	88	4	102		48	1219	41.57	1056	48	1219
6	152	5.20	132	6	152		50	1270	43.30	1100	50	1270
8	203	6.93	176	8	203		52	1321	45.03	1144	52	1321
10	254	8.66	220	10	254		54	1372	46.76	1188	54	1372
12	305	10.39	264	12	305		56	1422	48.50	1232	56	1422
14	356	12.12	308	14	356		58	1473	50.23	1276	58	1473
16	406	13.86	352	16	406		60	1524	51.96	1320	60	1524
18	457	15.59	396	18	457		62	1575	53.69	1364	62	1575
20	508	17.32	440	20	508		64	1626	55.42	1408	64	1626
22	559	19.05	484	22	559		66	1676	57.16	1452	66	1676
24	610	20.78	528	24	610		68	1727	58.89	1496	68	1727
26	660	22.52	572	26	660		72	1829	62.35	1584	72	1829
28	711	24.25	616	28	711		78	1981	67.55	1716	78	1981
30	762	25.98	660	30	762		84	2134	72.74	1848	84	2134
32	813	27.71	704	32	813		90	2286	77.94	1980	90	2286
34	864	29.44	748	34	864		96	2438	83.14	2112	96	2438
36	914	31.18	792	36	914		102	2591	88.33	2244	102	2591
38	965	32.91	836	38	965		108	2743	93.53	2376	108	2743
40	1016	34.64	880	40	1016		114	2896	98.72	2508	114	2896
42	1067	36.37	924	42	1067		120	3048	103.92	2640	120	3048
44	1118	38.10	968	44	1118		126	3200	109.12	2772	126	3200
46	1168	39.84	1012	46	1168		132	3353	114.31	2904	132	3353

Composites USA

One Peninsula Drive, North East, MD USA 21901  
 1-410-287-2700 Fax: 1-410-287-5222 info@compositesusa.com