

TANK I.D. D	DISH RADIUS R_D	DISH KNUCKLE RADIUS R_K	DISH HEIGHT H	DISH THICKNESS T	NOTES
	$R_D = D$	$R_K \geq 6\% D$.17 X D		STANDARD

J.L.=JOINT LINE
T.L.=TANGENT LINE
S.F.= STRAIGHT FLANGE

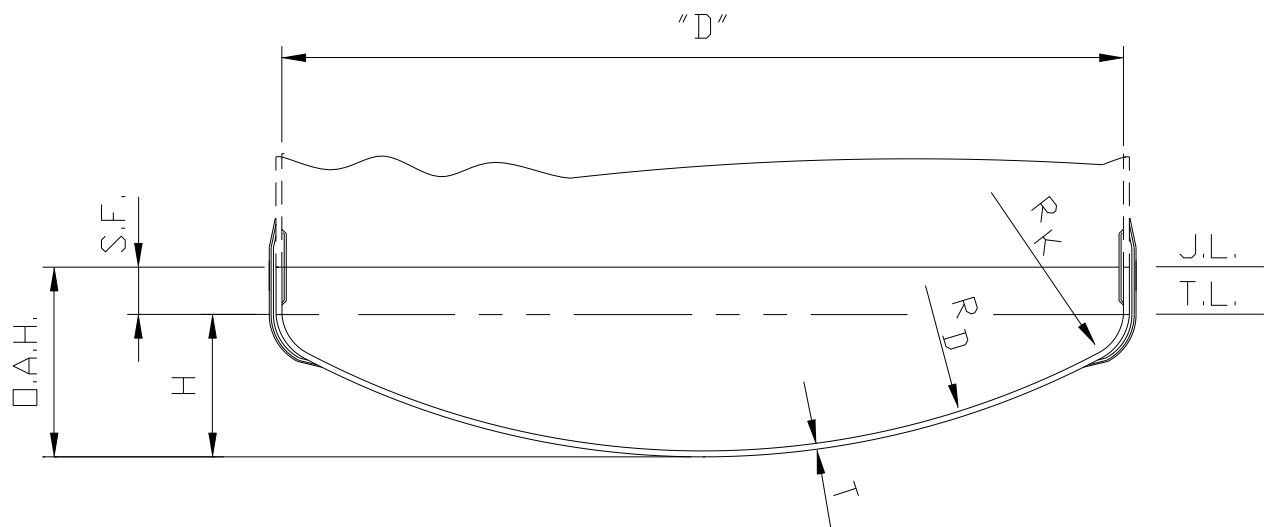

NOTES:

1. STANDARD DESIGN IS FOR THE WORST CASE ANALYSIS OF PRESSURE, AND VACUUM, IN ACCORDANCE WITH ASME RTP-1, ASTM D-3299 AND ASTM D-4097

No. VB-1030 ASME (TORISPHERICAL) DISHED BOTTOM

COMPOSITES USA

One Peninsula Drive, North East, MD USA 21901
1-410-287-2700 • fax:1-410-287-5222 info@compositesusa.com

Revision Date

Sheet 1 of 1

This drawing may not be reproduced without written permission of Composites USA, Inc.